

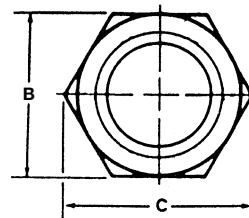

The bright purple nylon insert identifies Tork Lok Nuts and denotes precision manufacture from the finest materials, to assure top product performance. "Look for the Royal Purple Insert"

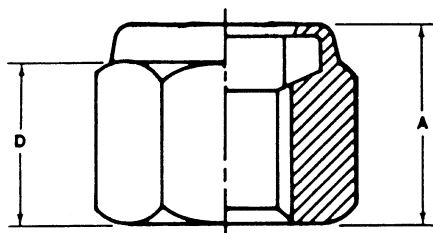

STAKE MARKS AVAILABLE

Size	Continental-Aero Part Number *See Note	Thread †See Note	Standard Container Quantity	Weight Lbs./C (Steel)	A Height **See Note	B Across Flats	C (Ref) Across Corners	D (Ref) Wrench Pad
¼	xxNU040	¼-20	4000	1.5	.375	.503-.489	.556	.290
⅕	xxNU058	⅕-18	2500	2.1	.438	.566-.551	.624	.335
⅜	xxNU066	⅜-16	1500	3.8	.547	.691-.675	.763	.392
⅞	xxNU074	⅞-14	1000	4.8	.594	.754-.736	.829	.464
	xxNU070	⅞-20						
½	xxNU083	½-13	700	8.2	.703	.879-.861	.969	.544
	xxNU080	½-20						
⅝	xxNU092	⅝-12	550	10.0	.797	.942-.922	1.037	.655
	xxNU098	⅝-18						
⅚	xxNU101	⅚-11	350	14.0	.859	1.067-.1.045	1.175	.677
	xxNU108	⅚-18						
¾	xxNU120	¾-10	250	23.0	1.000	1.255-.1.231	1.382	.790
	xxNU126	¾-16						
⅞	xxNU149	⅞-9	150	34.0	1.125	1.444-1.417	1.589	.883
	xxNU144	⅞-14						
1	xxNU168	1-8	100	48.0	1.281	1.632-1.602	1.796	1.000
	xxNU164	1-14						
	xxNU162	1-12						
1⅛	xxNU187	1⅛-7	92	69.0	1.438	1.820-1.788	2.002	1.096
	xxNU182	1⅛-12						
	xxNU188	1⅛-8						
1¼	xxNU207	1¼-7	72	92.0	1.641	2.008-1.973	2.209	1.250
	xxNU202	1¼-12						
	xxNU208	1¼-8						

**Locking Insert:** Purple nylon (250°F max. performance) white and staked available.

\* **Note:** See page 2 for parts nomenclature; substitute digits for material and finish in place of "xx" in part numbers above.

\*\* **Note:** TOLERANCES — ¼ through ⅝: ±.015; 1" through 1¼: ±.031.

† **Note:** Other thread sizes are available from stock or on application.



The bright purple nylon insert identifies Tork Lok Nuts and denotes precision manufacture from the finest materials, to assure top product performance. "Look for the Royal Purple Insert"

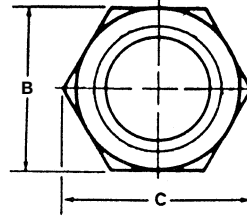
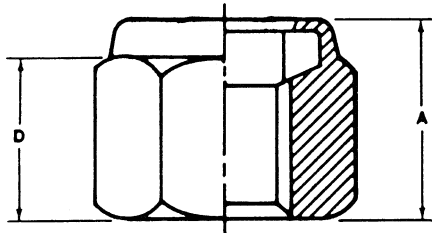

STAKE MARKS  
AVAILABLE

NU SERIES

Size	Continental-Aero Part Number *See Note	Thread †See Note	Standard Container Quantity	Weight Lbs./C (Steel)	A Height **See Note	B Across Flats	C (Ref) Across Corners	D (Ref) Wrench Pad
1 <sup>3</sup> / <sub>8</sub>	xxNU226	1 <sup>3</sup> / <sub>8</sub> -6	60	120.0	1.797	2.197-2.159	2.416	1.376
	xxNU222	1 <sup>3</sup> / <sub>8</sub> -12						
	xxNU228	1 <sup>3</sup> / <sub>8</sub> -8						
1 <sup>1</sup> / <sub>2</sub>	xxNU246	1 <sup>1</sup> / <sub>2</sub> -6	36	150.0	1.922	2.384-2.344	2.622	1.413
	xxNU242	1 <sup>1</sup> / <sub>2</sub> -12						
	xxNU248	1 <sup>1</sup> / <sub>2</sub> -8						
1 <sup>5</sup> / <sub>8</sub>	xxNU265	1 <sup>5</sup> / <sub>8</sub> -5	32	185.0	2.141	2.572-2.530	2.886	1.637
	xxNU262	1 <sup>5</sup> / <sub>8</sub> -12						
	xxNU268	1 <sup>5</sup> / <sub>8</sub> -8						
1 <sup>3</sup> / <sub>4</sub>	xxNU285	1 <sup>3</sup> / <sub>4</sub> -5	27	240.0	2.313	2.762-2.715	3.035	1.830
	xxNU282	1 <sup>3</sup> / <sub>4</sub> -12						
	xxNU288	1 <sup>3</sup> / <sub>4</sub> -8						
1 <sup>7</sup> / <sub>8</sub>	xxNU305	1 <sup>7</sup> / <sub>8</sub> -5	24	270.0	2.359	2.950-2.901	3.242	1.875
	xxNU302	1 <sup>7</sup> / <sub>8</sub> -12						
	xxNU308	1 <sup>7</sup> / <sub>8</sub> -8						
2	xxNU324	2-4 <sup>1</sup> / <sub>2</sub>	15	310.0	2.406	3.137-3.086	3.449	1.750
	xxNU322	2-12						
	xxNU328	2-8						
2 <sup>1</sup> / <sub>4</sub>	xxNU364	2 <sup>1</sup> / <sub>4</sub> -4 <sup>1</sup> / <sub>2</sub>	12	450.0	2.813	3.514-3.457	3.862	2.063
	xxNU362	2 <sup>1</sup> / <sub>4</sub> -12						
	xxNU368	2 <sup>1</sup> / <sub>4</sub> -8						
2 <sup>1</sup> / <sub>2</sub>	xxNU404	2 <sup>1</sup> / <sub>2</sub> -4	8	682.0	3.141	4.015-3.875	4.618	2.475
	xxNU402	2 <sup>1</sup> / <sub>2</sub> -12						
	xxNU408	2 <sup>1</sup> / <sub>2</sub> -8						
2 <sup>3</sup> / <sub>4</sub>	xxNU444	2 <sup>3</sup> / <sub>4</sub> -4	8	530.0	3.141	4.015-3.875	4.618	2.350
	xxNU442	2 <sup>3</sup> / <sub>4</sub> -12						
	xxNU448	2 <sup>3</sup> / <sub>4</sub> -8						
3	xxNU484	3-4	4	1000.0	3.641	4.640-4.500	5.102	2.750
	xxNU482	3-12						
	xxNU488	3-8						

**Locking Insert:** Purple nylon (250°F max. performance) white and staked available.

\* **Note:** See page 2 for parts nomenclature; substitute digits for material and finish in place of "xx" in part numbers above.

\*\* **Note:** TOLERANCES — 1<sup>3</sup>/<sub>8</sub> through 1<sup>1</sup>/<sub>2</sub>: ±.031; 1<sup>1</sup>/<sub>2</sub> through 3": ±.063.

† **Note:** Other thread sizes are available from stock or on application.